

PRODUCT DATA SHEET
FREEfold
Fold lift system for divided front panels

- Multi-Position-Stopp & stepless force adjustment
- ClickFixx and 3D-frontadjustment
- Positioning pins
- Premounted screws
- finger trap protection integrated in central hinge



Cabinet type		WALL UNIT / LIFTER	
Fitting type		Folding flap fitting	
Application area		Folding flap cabinets	
(Carcase dimensions in mm)	Front panel width	Up to 1800	
	Front panel height (2 front panels + gap)	450 to 1040	
	Front panel weight	Height-dependent	1.5 to 29 kg
	Front panel thickness	Max.	32
Installation dimensions			
(Carcase dimensions in mm)	Required height	Carcase to ceiling	Dependent on lever arm & front panel dimensions
	Clear depth	288	
	Clear height	Dependent on lever arm length	
	Front panel connectors	110°	Concealed hinge
	Centre shelf recess	25	
Movement system			
	Drive/power pack	Coiled compression spring	3 variants
	lever arms	11 variants	
Design variants			
	Colours/finishes	Cover	7035 (RAL light grey); 9966 (KB white)
		Internal plastic parts	7040 (RAL window grey)
		Fitting arm	Nickel-plated
Assembly/adjustment			
(in mm)	Front panel connectors	Top	110° concealed hinge
	ClickFixx	Front panel connectors	x
	Hole pattern	System 32 for carcase	x
		System 32 for front panel	x
	Force adjustment	Nonius	x
	3D adjustment (centre hinge)	Height	+/- 1.5
		Width	+/- 1.5
		Tilt	+/- 1.5
	1D adjustment (front connector)	Tilt	x
	3D adjustment (concealed hinge)	Dependent on type of hinge	
	With positioning pins	x	
	With premounted screws	Euro	x
Comfort features			
	SoftSTOPP	x	
	Multi-Position-STOPP	x	
	eTouch	3rd quarter 2014	
Weight			
(in kg)	Fitting	Incl. front panel connectors	1.26
Materials			
	Fitting	Steel	x
	Cover	Plastic	x

PRODUCT DATA SHEET

FREEfold

Accessories		
Opening angle delimiter		TBD
Adapter for 20x20 aluminium frame		x
Push-to-open		-
Packaging units		
Single	1	x
Multiple	5	-
	10	x
Returnable		In preparation
Quality certificate		
LGA		In planning
Dates		
Product release		Summer 2014

Variable fitting dimensions:

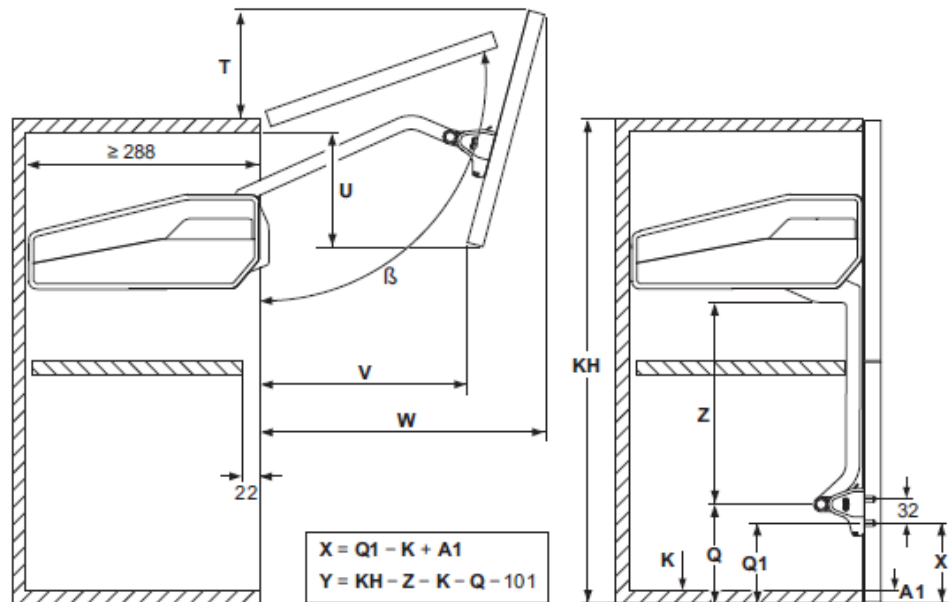

Drilling pattern:

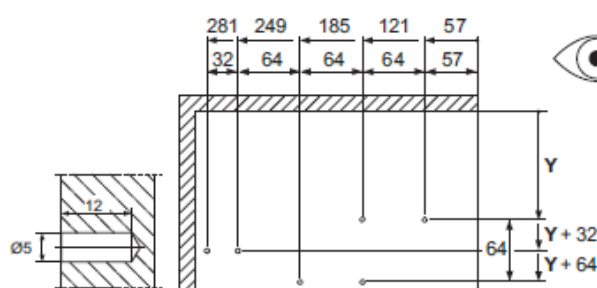

	β [°]	Q1	Q	Z	T	U	V	W
450 - 480	-97-107	36,5	62	186	94-41	93-127	196-172	315-345
480 - 530	-94-108	51,5	77	201	99-28	100-153	202-176	329-371
520 - 590	-92-108	67,5	93	220	106-13	112-181	213-178	347-402
580 - 650	-93-108	97,5	123	250	118-18	126-188	225-179	375-433
650 - 730	-92-107	125,5	151	282	124-14	147-211	238-184	410-473
710 - 790	-93-108	155,5	181	312	136-18	161-214	249-182	438-504
770 - 840	-95-108	177,5	203	340	146-43	179-223	267-200	466-527
840 - 910	-95-108	213,5	239	374	154-42	195-222	272-190	501-563
910 - 970	-97-107	241,5	267	406	160-64	214-232	282-205	536-591
960 - 1010	-99-107	262,5	288	430	169-89	228-240	295-222	560-607
1000 - 1040	-101-108	278,5	304	449	177-113	239-249	305-243	578-618