

**INSTRUCCIONES DE MONTAJE
ASSEMBLY INSTRUCTIONS
INSTRUCCIONS DE MONTAGE**

**puertas correderas colgantes de paso
top hung sliding doors
portes coulissantes suspendues de pas**

1 carril a pared · single rail wall mounted · rail au mur

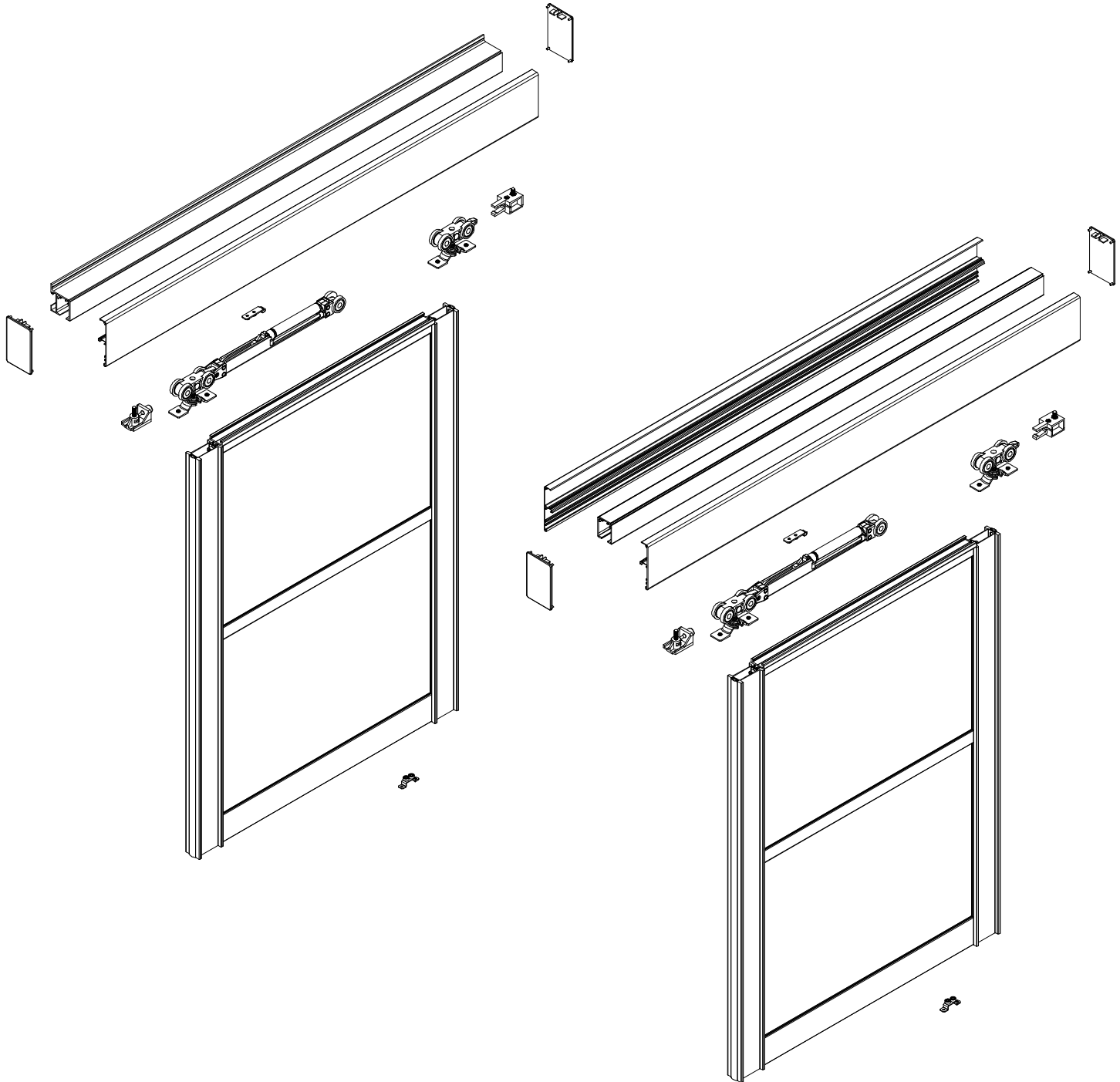

2 carril a techo · single & dual rails ceiling mounted · rail au plafond

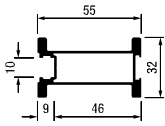

A
tirador
handle profile
profil vertical
TR-BASE55

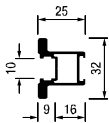

A
tirador
handle profile
profil vertical
TR-BASE25

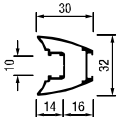

A
tirador
handle profile
profil vertical
TR-BASE-S1

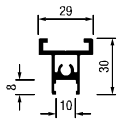

B
perfil horizontal superior "U"
"U" horizontal upper profile
profil horizontal supérieur "U"
RS-BASE-TOP

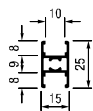

C
perfil horizontal central "H"
"H" horizontal central profile
profil horizontal central "H"
RC-BASE

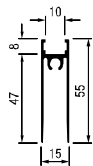

D
perfil horizontal inferior "U"
"U" horizontal bottom profile
profil horizontal inférieur "U"
RI-BASE

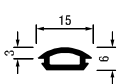

E
perfil pvc lateral
pvc side profile
profil latéral pvc



F
perfil "U" para cristal
"U" fitting for glass
profil "U" pour verre

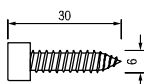

G
tornillo ensamble M6x30
assembly screw M6x30
vis d'assemblage M6x30

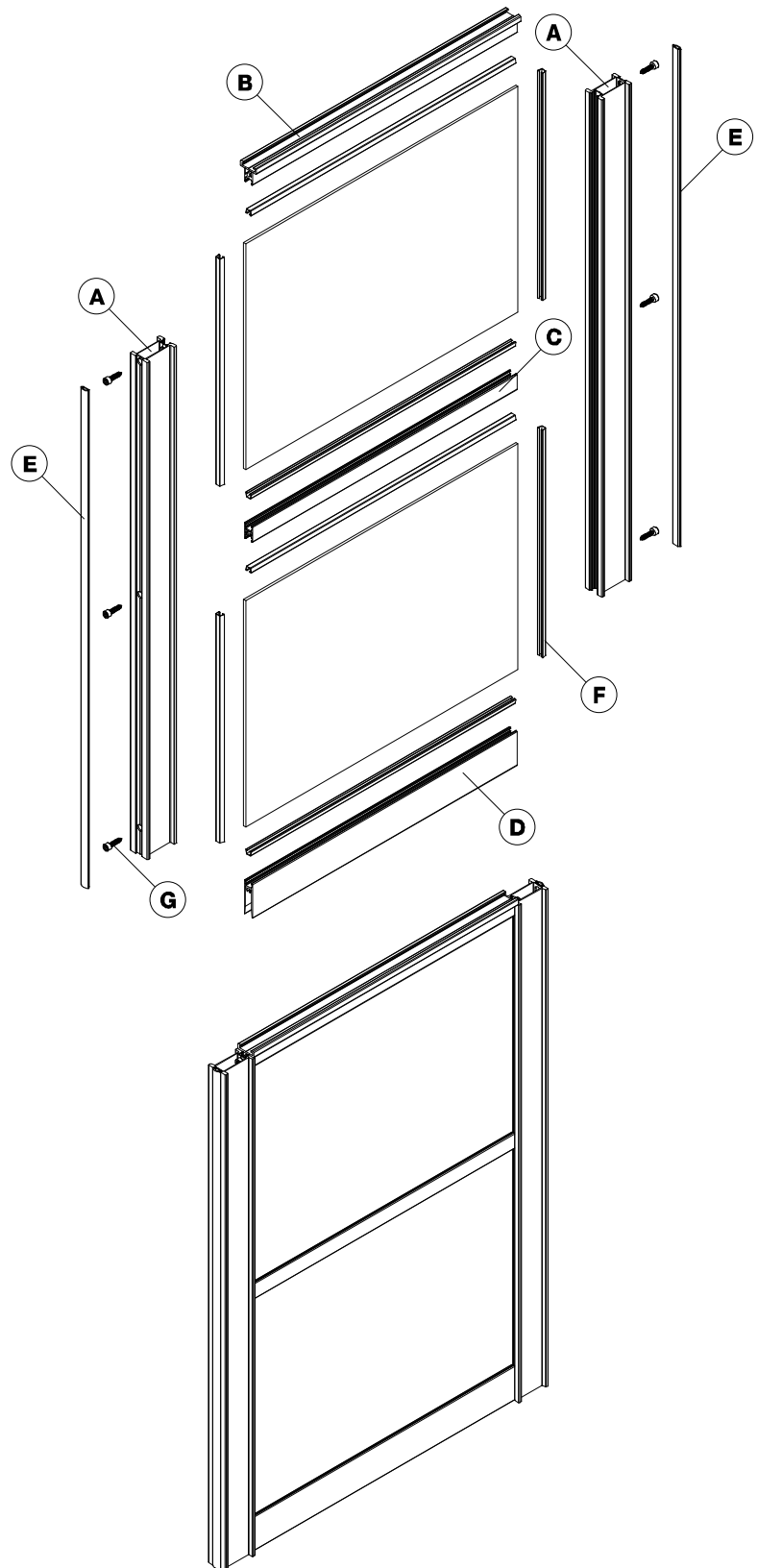

1

carril a pared · single rail wall mounted · rail au mur

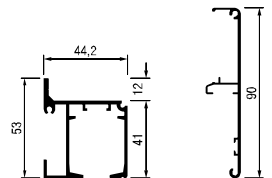
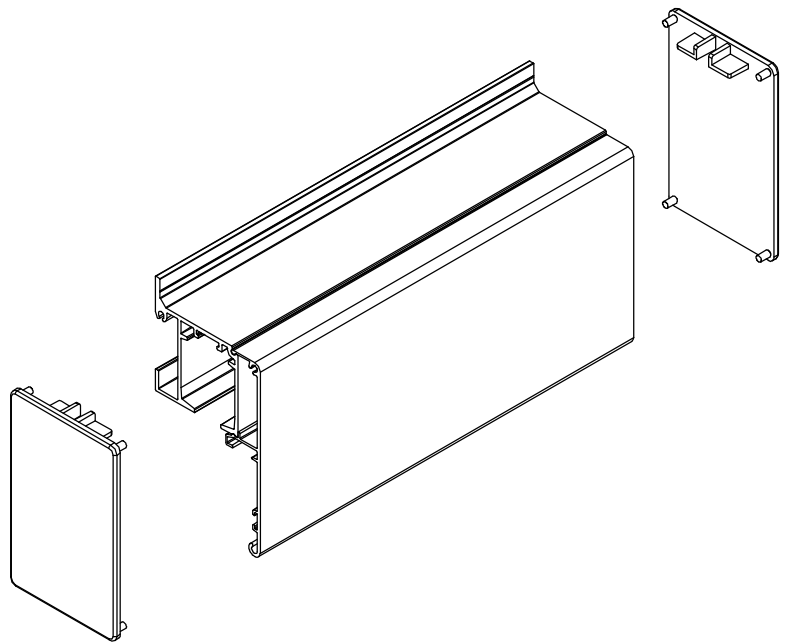
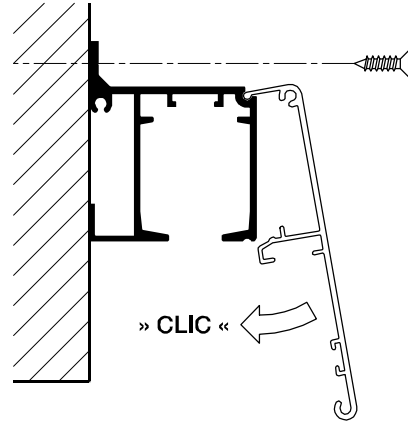
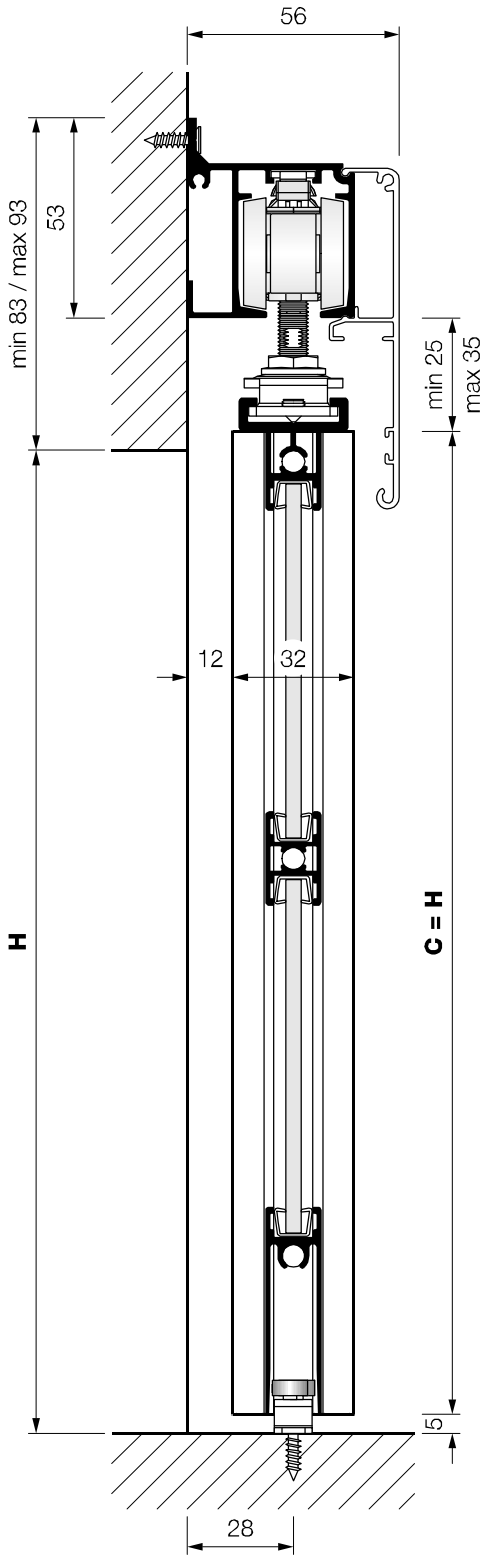

H alto hueco de luz · open area height · hauteur du creux

C alto de puerta · door height · hauteur de la porte

1

carril a techo · single & dual rails ceiling mounted · rail au plafond

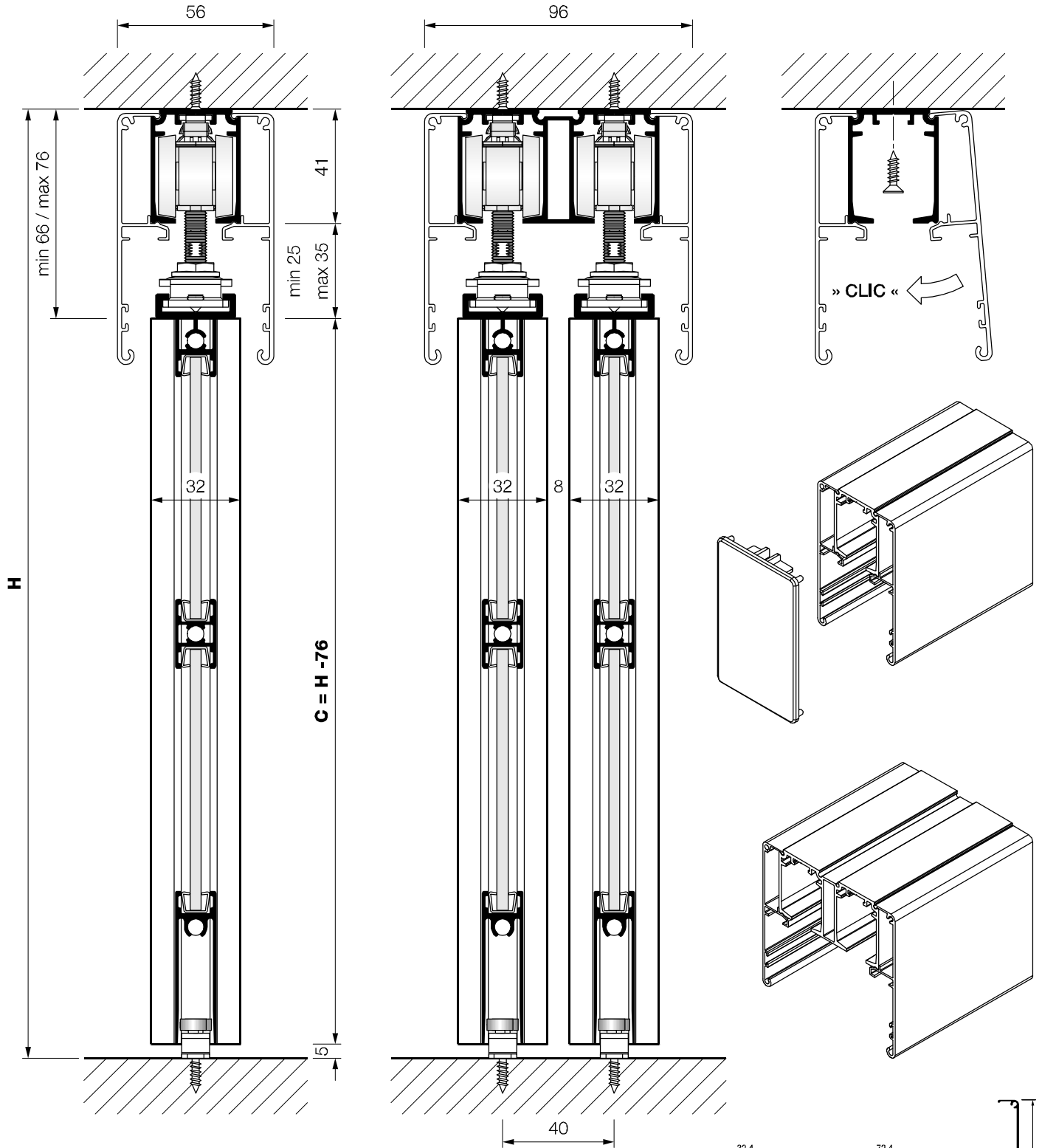

H alto hueco de luz · open area height · hauteur du creux

C alto de puerta · door height · hauteur de la porte

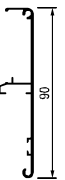
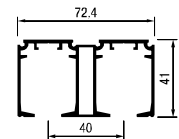
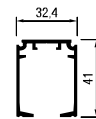

alto de puerta · door height · hauteur de la porte

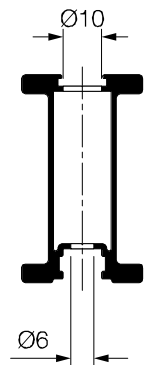
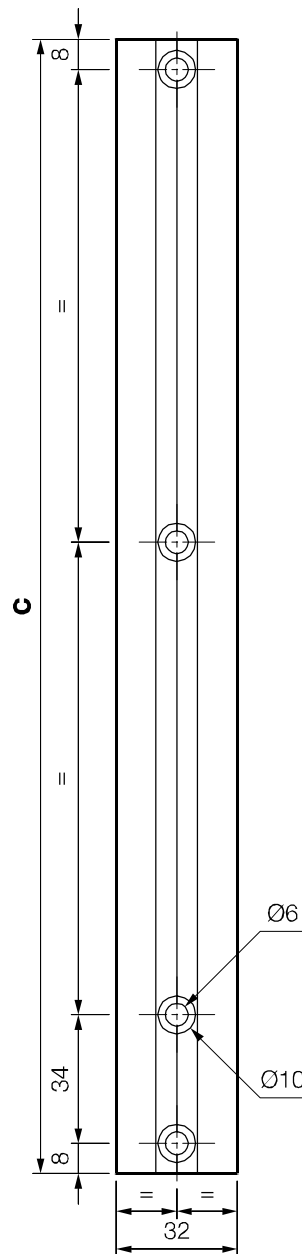
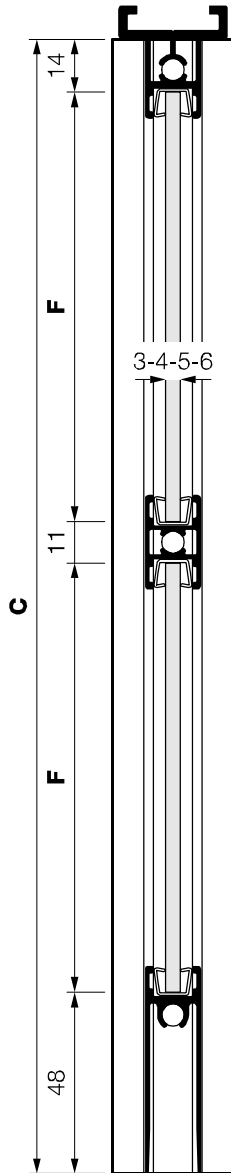
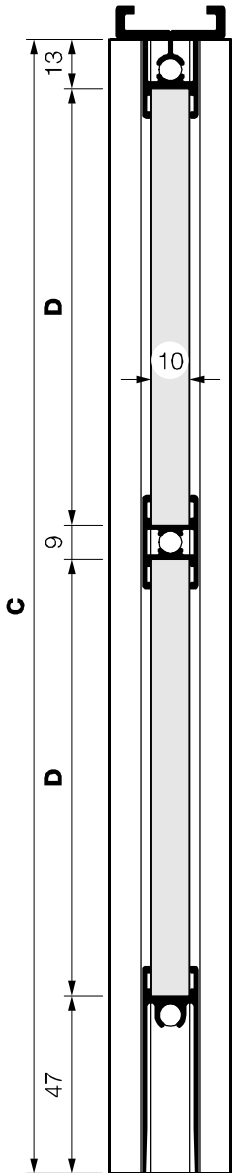

mecanizados tirador
handle profile mechanized
mécanisés profil vertical

divisiones "H" · "H" divisions · divisions "H"

0	$D = C - 60$	$F = C - 62$
1	$D = \frac{C}{2} - 34,5$	$F = \frac{C}{2} - 36,5$
2	$D = \frac{C}{3} - 26$	$F = \frac{C}{3} - 28$
3	$D = \frac{C}{4} - 21,75$	$F = \frac{C}{4} - 23,75$
4	$D = \frac{C}{5} - 19,2$	$F = \frac{C}{5} - 21,2$

5	$D = \frac{C}{6} - 17,5$	$F = \frac{C}{6} - 19,5$
6	$D = \frac{C}{7} - 16,28$	$F = \frac{C}{7} - 18,28$

C alto de puerta · door height · hauteur de la porte
D alto de tablero · board height · hauteur du panneau
F alto de cristal · glass height · hauteur du verre

ancho de puerta · door width · largeur de la porte

- A** ancho de puerta · door width · largeur de la porte
- B** ancho de tablero · board width · largeur du panneau
- E** ancho de cristal · glass width · largeur du verre
- R** perfil horizontal · horizontal profile · profil horizontal

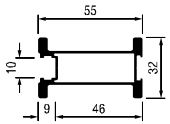

TR-BASE55

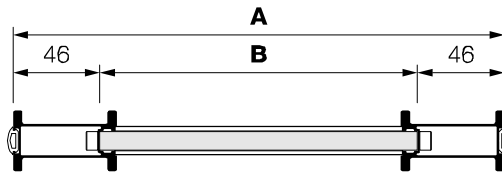

$$B = A - 92 \text{ mm}$$

$$E = A - 94 \text{ mm}$$

$$R = A - 108 \text{ mm}$$

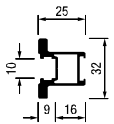
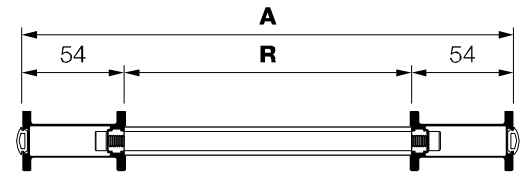
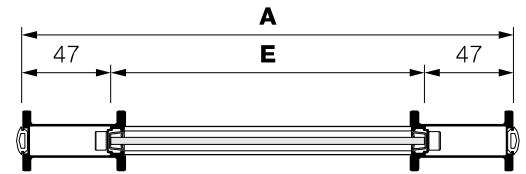

TR-BASE25

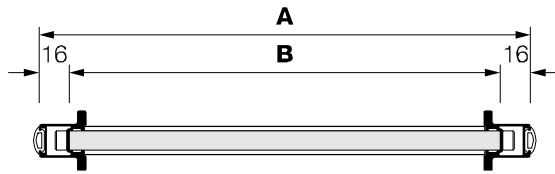

$$B = A - 32 \text{ mm}$$

$$E = A - 34 \text{ mm}$$

$$R = A - 48 \text{ mm}$$

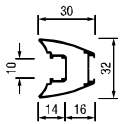
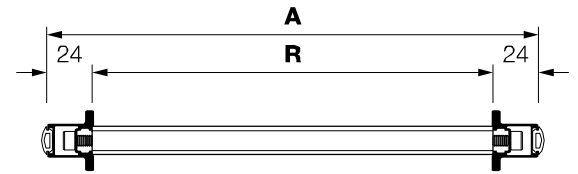
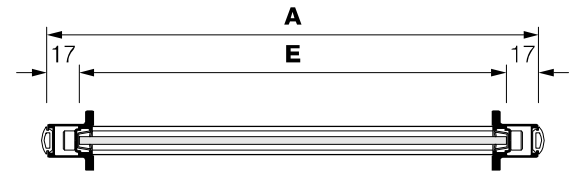

TR-BASE-S1

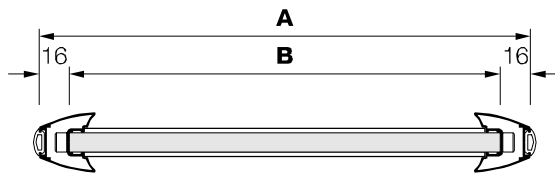

$$B = A - 32 \text{ mm}$$

$$E = A - 34 \text{ mm}$$

$$R = A - 48 \text{ mm}$$

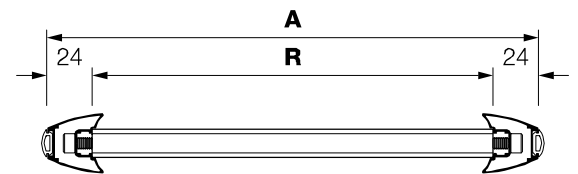
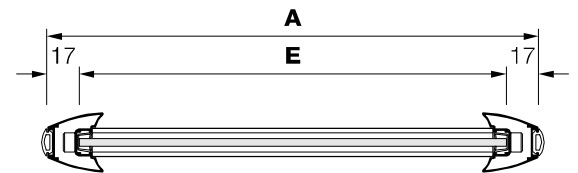

1

carril a pared · single rail wall mounted · rail au mur

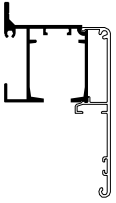

1 puerta con carril individual · 1 door with single rail · 1 porte avec rail simple

longitud de carril
rail length
longueur du rail
= 2 x A

TR-BASE55

$$A = L + 55 \text{ mm}$$

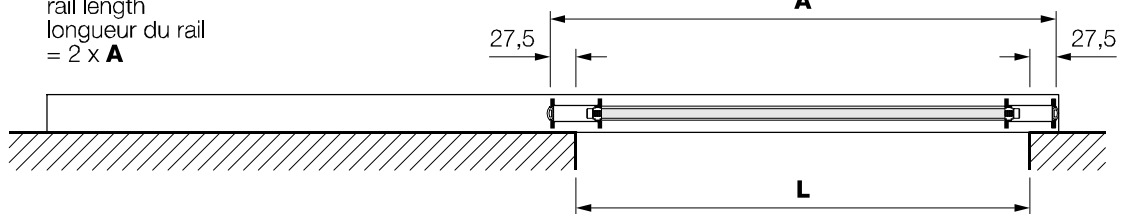

TR-BASE25

$$A = L + 25 \text{ mm}$$

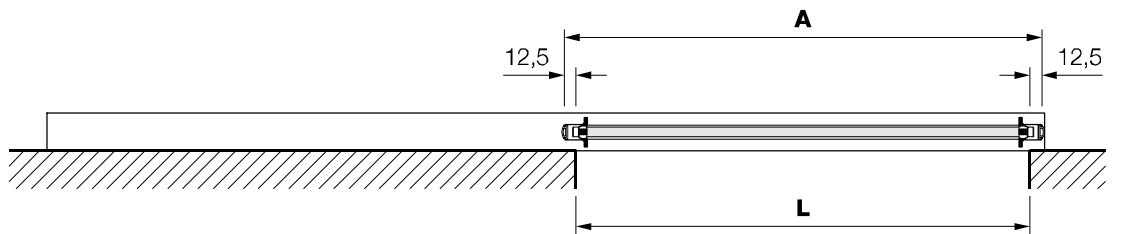

TR-BASE-S1

$$A = L + 30 \text{ mm}$$

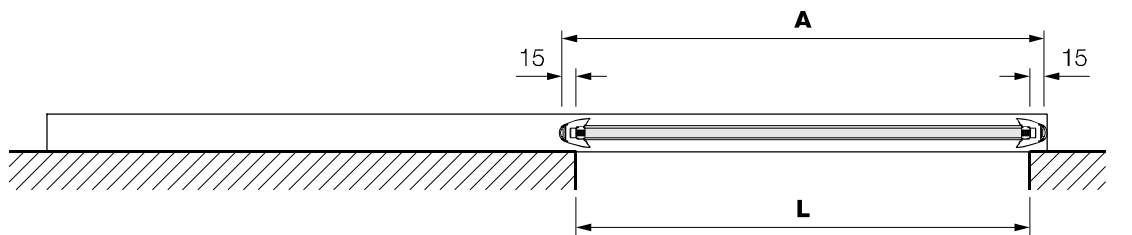

2 puertas con carril individual · 2 doors with single rail · 2 portes avec rail simple

longitud de carril
rail length
longueur du rail
= 4 x A

TR-BASE55

$$A = \frac{L}{2} + 24,5 \text{ mm}$$

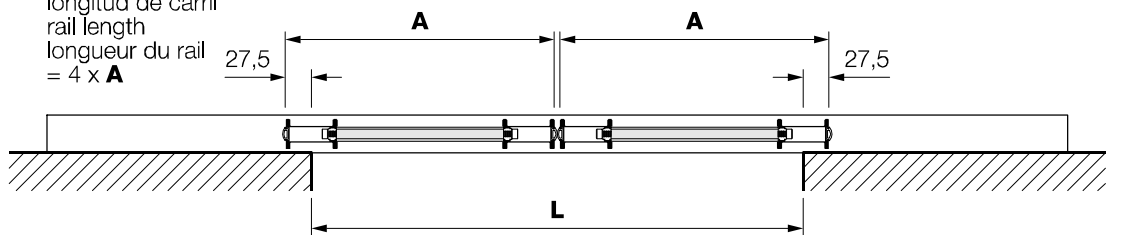

TR-BASE25

$$A = \frac{L}{2} + 9,5 \text{ mm}$$

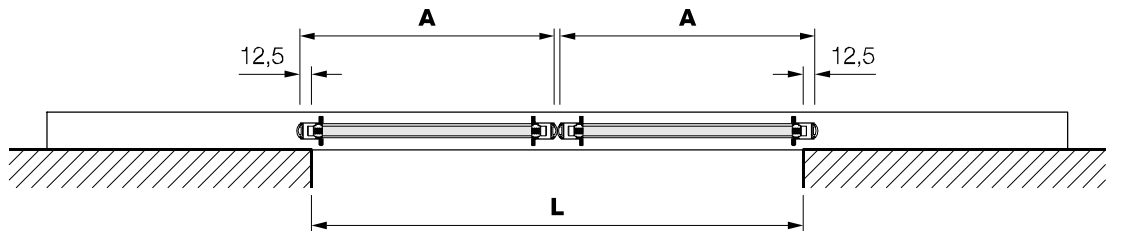

TR-BASE-S1

$$A = \frac{L}{2} + 12 \text{ mm}$$

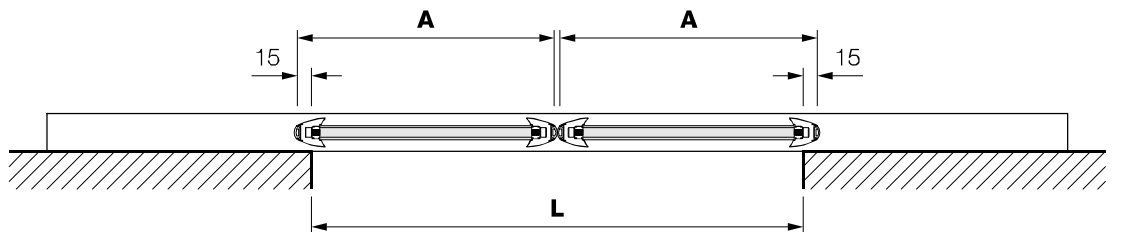

2

carril a techo · single & dual rails ceiling mounted · rail au plafond

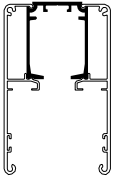

TR-BASE55

$$A = L + 24,5 \text{ mm}$$

1 puerta con carril individual · 1 door with single rail · 1 porte avec rail simple

longitud de carril
rail length
longueur du rail
= 2 x A

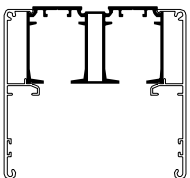
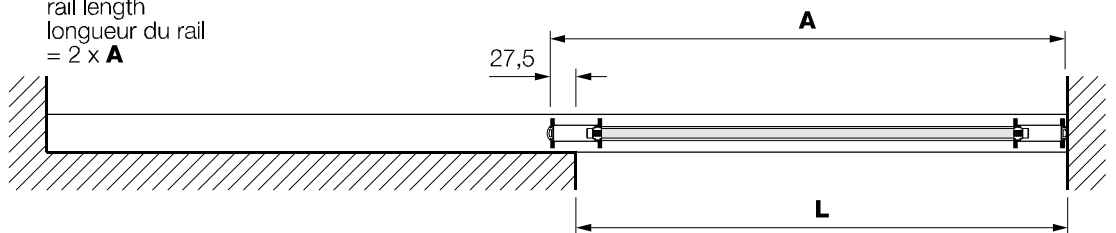

TR-BASE55

$$A = \frac{L}{2} + 24,5 \text{ mm}$$

2 puertas con carril doble · 2 doors with dual rail · 2 portes avec rail double

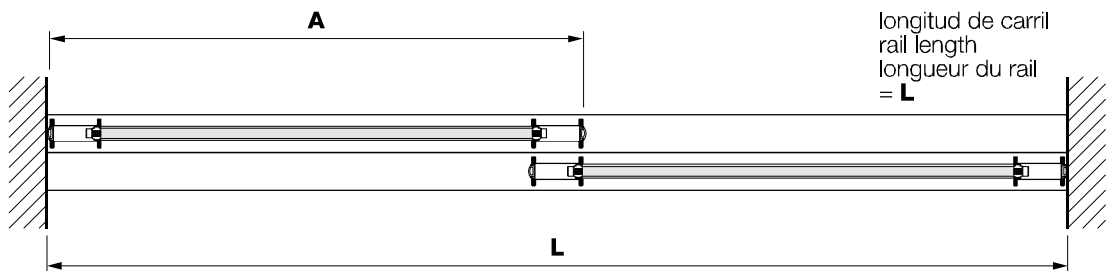

TR-BASE55

$$A = \frac{L}{3} + 34,5 \text{ mm}$$

3 puertas con carril doble · 3 doors with dual rail · 3 portes avec rail double

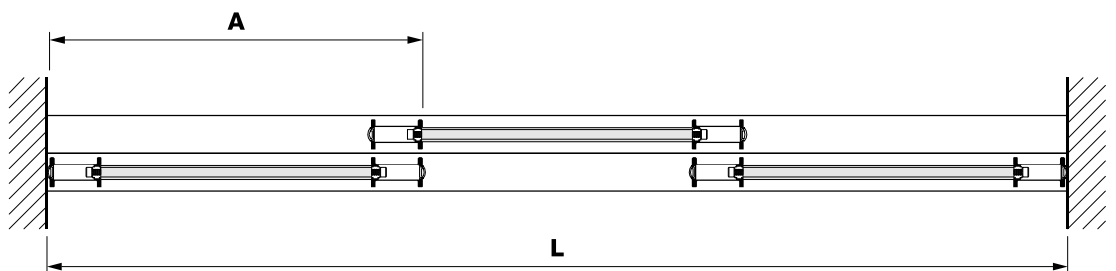

TR-BASE55

$$A = \frac{L}{4} + 24,5 \text{ mm}$$

4 puertas con carril doble · 4 doors with dual rail · 4 portes avec rail double

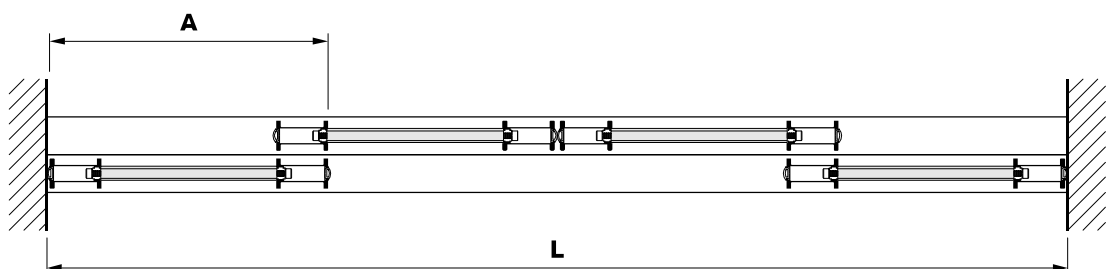

L ancho hueco de luz · open area width · largeur du creux

A ancho de puerta · door width · largeur de la porte

configuración horizontal de puertas horizontal configuration of doors configuration horizontale de portes

2

carril a techo · single & dual rails ceiling mounted · rail au plafond

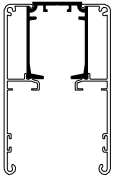

TR-BASE25

$$A = L + 9,5 \text{ mm}$$

1 puerta con carril individual · 1 door with single rail · 1 porte avec rail simple

longitud de carril
rail length
longueur du rail
= 2 x A

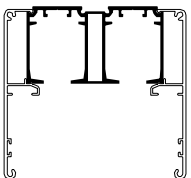
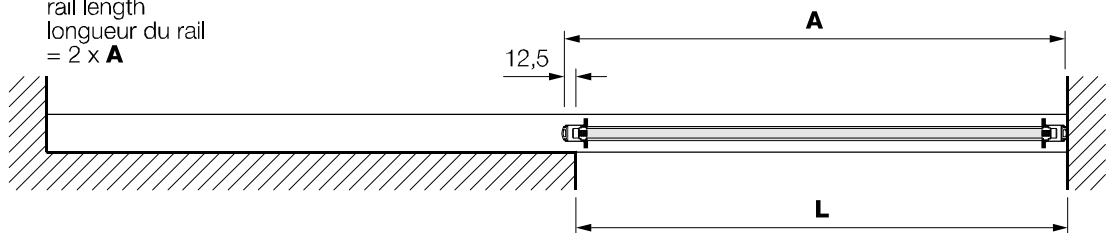

TR-BASE25

$$A = \frac{L}{2} + 9,5 \text{ mm}$$

2 puertas con carril doble · 2 doors with dual rail · 2 portes avec rail double

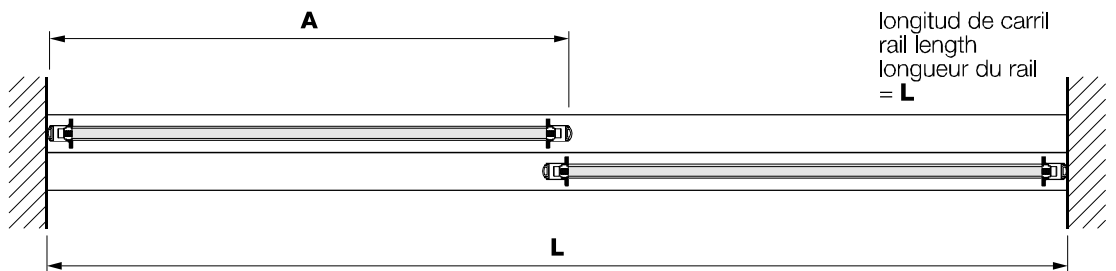

TR-BASE25

$$A = \frac{L}{3} + 14,5 \text{ mm}$$

3 puertas con carril doble · 3 doors with dual rail · 3 portes avec rail double

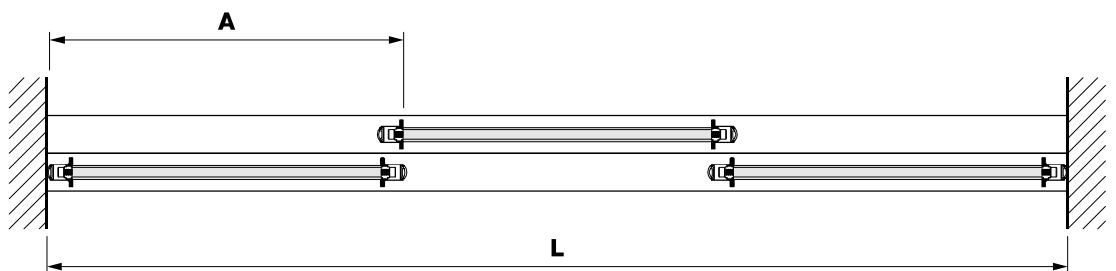

TR-BASE25

$$A = \frac{L}{4} + 9,5 \text{ mm}$$

4 puertas con carril doble · 4 doors with dual rail · 4 portes avec rail double

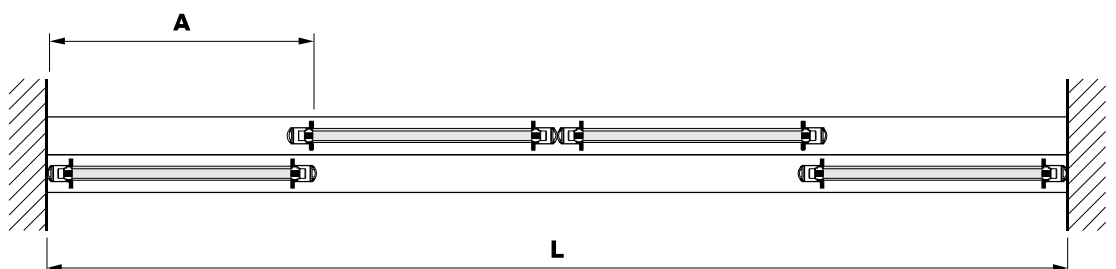

L ancho hueco de luz · open area width · largeur du creux

A ancho de puerta · door width · largeur de la porte

configuración horizontal de puertas horizontal configuration of doors configuration horizontale de portes

2

carril a techo · single & dual rails ceiling mounted · rail au plafond

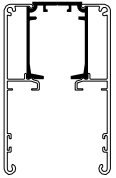

TR-BASE-S1

$$A = L + 12 \text{ mm}$$

1 puerta con carril individual · 1 door with single rail · 1 porte avec rail simple

longitud de carril
rail length
longueur du rail
= 2 x A

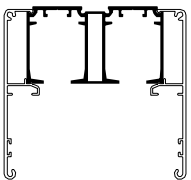
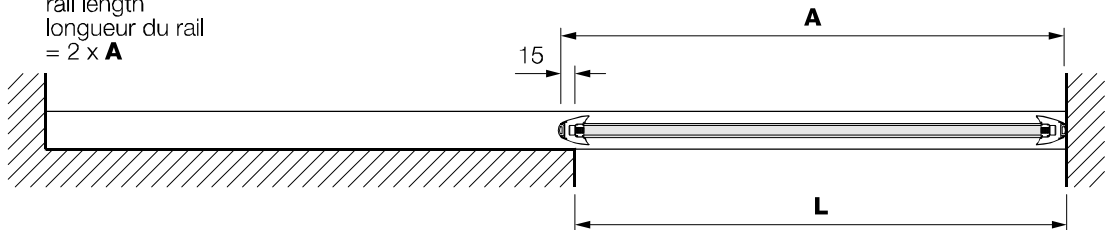

TR-BASE-S1

$$A = \frac{L}{2} + 12 \text{ mm}$$

2 puertas con carril doble · 2 doors with dual rail · 2 portes avec rail double

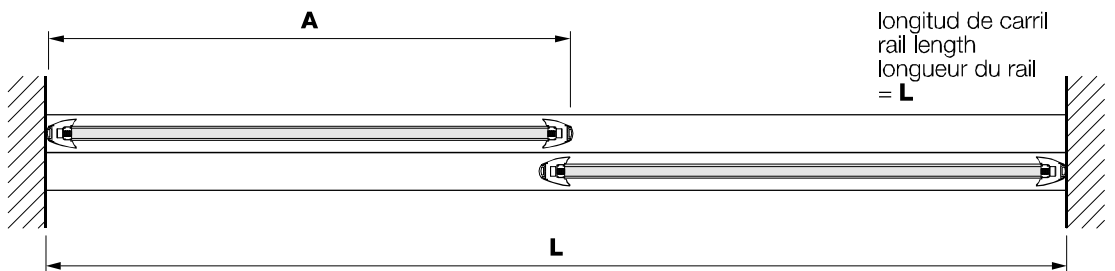

TR-BASE-S1

$$A = \frac{L}{3} + 18 \text{ mm}$$

3 puertas con carril doble · 3 doors with dual rail · 3 portes avec rail double

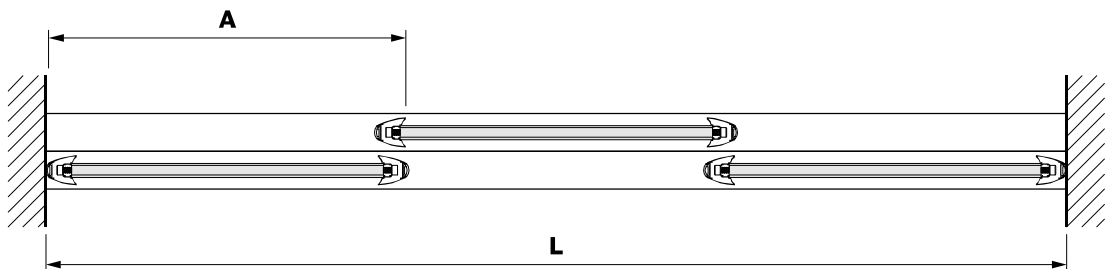

TR-BASE-S1

$$A = \frac{L}{4} + 12 \text{ mm}$$

4 puertas con carril doble · 4 doors with dual rail · 4 portes avec rail double

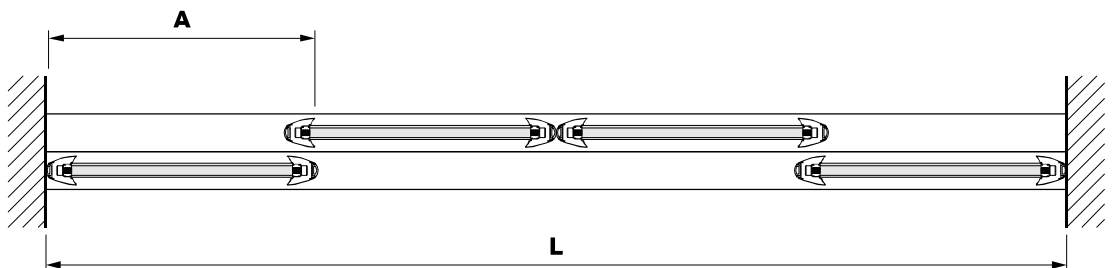

L ancho hueco de luz · open area width · largeur du creux

A ancho de puerta · door width · largeur de la porte

montaje de ruedas · rollers assembly · assemblage de roues

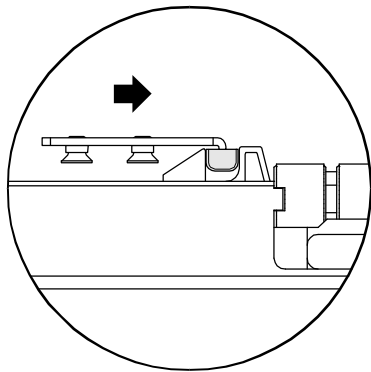

posición del activador
activator positioning
position de l'activateur

