



KAPSA

KAPSA's classic, reduced forms make it a power strip that is both design-orientated and space-saving – designed for the kitchen, office and many other areas in living and work environments.

The lid – which can be flipped open and changed – provides protection against external influences and is available in several versions. Modular equipment options make flexible configuration in several lengths possible.

Installation from above guarantees simple mounting – also optionally available for subsequent assembly. A low mounting depth of approx. 45 mm and a solid design characterise KAPSA and confirm that: less is more.

BENEFITS

- **Easily interchangeable lid available in various versions**
- **Modular equipment options**
- **Aluminium lid with high-quality feel**
- **Low mounting depth (approx. 45 mm)**
- **Simple mounting from above, retrofitting possible too**



Dimensions (W x H x D): see table x 50 x 70 mm

Mounting depth without cable: 45 mm

Material: Lid: aluminium
Socket: plastic, aluminium

Thickness of tabletop: 10–40 mm

Socket colour: black

Colour variants:



KAPSA lids

#	
Small Width: 204mm	
927.100	Stainless steel look
927.101	Black (painted, similar to RAL9005)
927.102	White (painted, similar to RAL9010)
927.103	Aluminium (anodised E6/EV1)
X-small Width: 151 mm	
927.300	Stainless steel look
927.301	Black (painted, similar to RAL9005)
927.302	White (painted, similar to RAL9010)
XX-small Width: 68mm	
927.500	Stainless steel look
927.501	Black (painted, similar to RAL9005)
927.502	White (painted, similar to RAL9010)



Lid can be changed
and easily retrofitted.

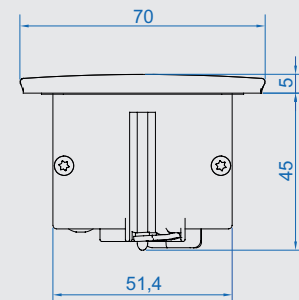
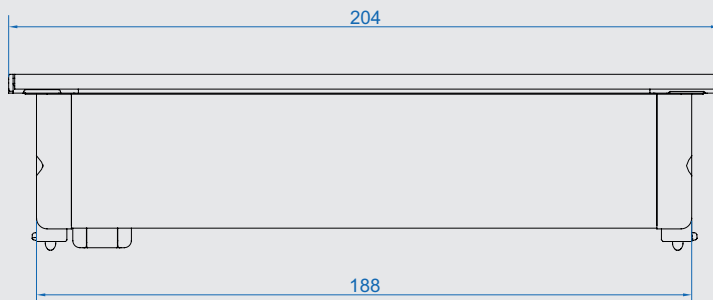

KAPSA - Small | Dimensions in mm



Other colour versions available on request

For suitable **power strips**, see from page 130.



For **Custom Modules***, see from page 197.

Small KAPSA power strips

#									
---	--	--	--	--	--	--	--	--	--

Power input: 0.2m cable with GST18i3 | Width 204 mm

927.050	3							35°		
927.051	2							35°	●	
927.052	2							35°		1
927.062	1							35°		2
927.058		2						90°		1
927.057		1						90°	●	1
927.053			3					35°		
927.054			2					35°	●	
927.055			2					35°		1
927.064			1					35°		2
927.059				3				0°		
927.060				2				0°	●	
927.061				2				0°		1

Power input: 2.0m cable with ferrules and mounting plug | Width 204 mm

927.000	3							35°		
927.001	2							35°	●	
927.002	2							35°		1
927.003			3					35°		
927.004			2					35°	●	
927.005			2					35°		1
927.009				3				0°		
927.010				2				0°	●	
927.011				2				0°		1
927.013					3			35°		
927.015					2			35°	●	

Power input: 2.0m cable with mounted UK plug | Width 204 mm

927.006		3 (13A)						90°		
927.012		2 (13A)						90°	●	
927.008		2 (13A)						90°		1
927.007		1 (13A)						90°	●	1



CONNECTION PANELS

Power strip and lid must be ordered separately

For suitable **device supply cables**, see from page 64.

For **Custom Modules***, see from page 197.

X-small KAPSA power strips

#						
Power input: 0.2m cable with GST18i3 Width 151 mm						
927.251	1				90°	●
927.257		1			90°	●
927.254			1		90°	●
927.260				1	0°	●
Power input: 2.0m cable with ferrules and mounting plug Width 151 mm						
927.200	2				90°	
927.201	1				90°	●
927.203			2		90°	
927.204			1		90°	●
927.209				2	0°	
927.210				1	0°	●
Power input: 2.0m cable with mounted UK plug Width 151 mm						
927.206		2 (13A)			90°	
927.207		1 (13A)			90°	●



CONNECTION PANELS

XX-small KAPSA power strips

#						
Power input: 2.0m cable with ferrules and mounting plug Width 68 mm						
927.400	1				90°	
927.402			1		90°	
927.404				1	90°	
927.410						1
Power input: 2.0m cable with mounted UK plug Width: 68 mm						
927.406		1			90°	



Power strip and lid must be ordered separately

For suitable **device supply cables**, see from page 64.

For **Custom Modules***, see from page 197.

* Observe compatibility table on page 197 onwards.

Pictograms and their meanings can be found on page 319.