

# “Flexible cabinet width and efficient installation ”

LIVE YOUR LIFE | CEMUX.CO.UK



## SW sliding system

In line sliding system - SWL001

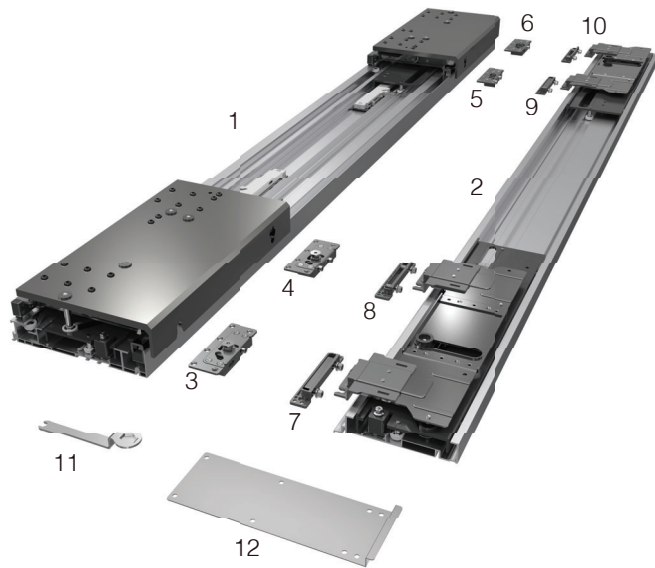

- In line sliding system
- Door height  $\leq 2400\text{mm}$
- Soft-close system
- 80KG single door loading capacity
- Damper with anti jumping and anti-decoupling
- 45mm door thickness



	Item	Quantity (2 doors)
1	Top track	1 pc
2	Bottom track	1 pc
3 & 6	Top runner side regulator	2 pcs
4 & 5	Top runner middle regulator	2 pcs
7 & 10	Bottom runner side regulator	2 pcs
8 & 9	Bottom runner middle regulator	2 pcs
11	Spanner	1 pc
12	Drill position template	1 pc

Item No.	Internal cabinet width	Track length	Remark
SWL001-1	1350-1650mm	1350-1650mm	Cut freely within the range
SWL001-2	1651-2050mm	1651-2050mm	Cut freely within the range
SWL001-3	2051-2450mm	2051-2450mm	Cut freely within the range
SWL001-4	2451-2850mm	2451-2850mm	Cut freely within the range

## Cabinet requirements

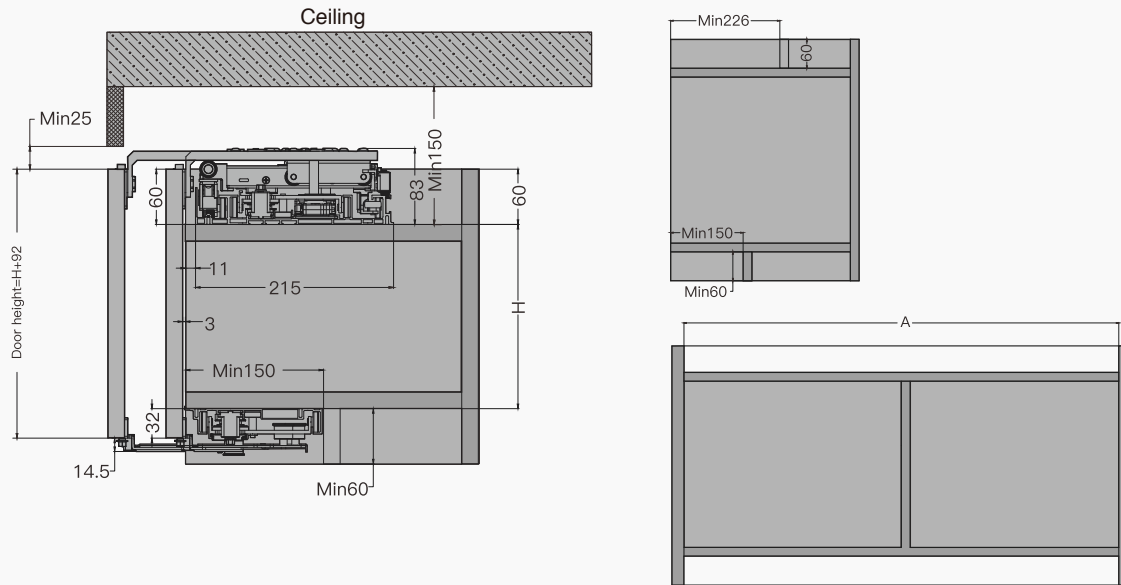

## Door dimension

\*Door overlay

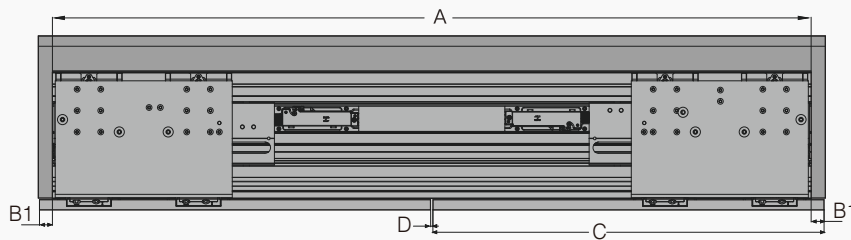

Door thickness (Handle include) ≤ 45mm

Door height ≤ 2400mm

Door overlay width =  $(A+2 \times B1-D)/2$

Door inset width =  $(A-2 \times B2-D)/2$

\*Door inset

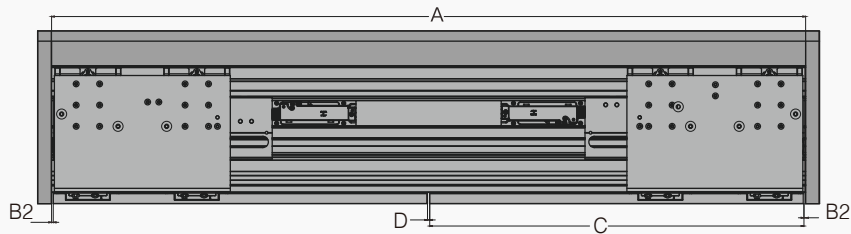

A = Internal cabinet width

B1 = Cover side panel width

B2 = Gap of door and side panel

C = Door width

D = Gap of door ≥ 4mm

## Door installation

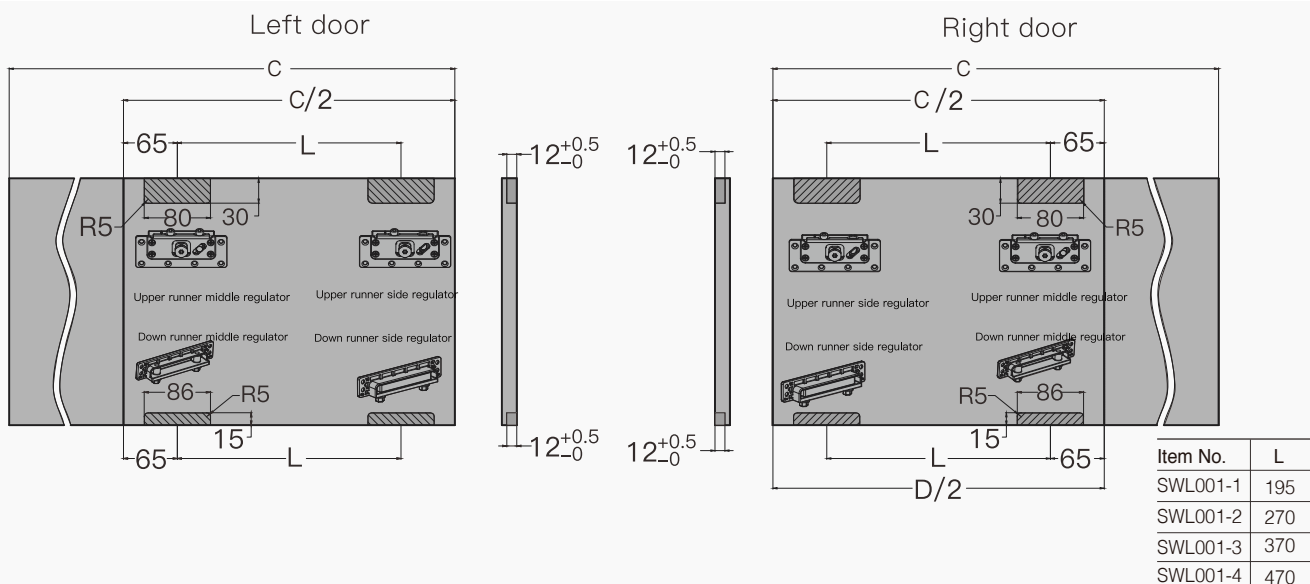

Item No.	L
SWL001-1	195
SWL001-2	270
SWL001-3	370
SWL001-4	470